



GENERAL & TECHNICAL INFORMATION

Skirball Center for the Performing Arts

www.nyuskirball.org

212.992.8484

August 2025

Skirball Center for the Performing Arts

TABLE OF CONTENTS

GENERAL INFORMATION	3
CONTACTS	4
FACILITY	5
LOADING IN, TRUCK PARKING, AND PERMITS	6
CARPENTRY	7
LIGHTING	10
AUDIO	13
VIDEO	15
PROPS AND WARDROBE	16
DRESSING & REHEARSAL ROOMS	17
THEATER DRAWINGS	18



Skirball Center for the Performing Arts

GENERAL INFORMATION

MAILING ADDRESS

NYU Skirball Center for the Performing Arts
Administrative Offices
60 Washington Square South, Suite 505
New York, NY 10012

THEATER ADDRESS, BOX OFFICE, AND AUDIENCE ENTRANCE

566 LaGuardia Place
New York, NY 10012

STAGE DOOR (AT SPECIFIED CALL TIMES ONLY)

566A LaGuardia Place at West 3rd Street
Please send stage door access list to Production Manager one week prior to your first day in the space.

LOADING DOCK (BY APPOINTMENT ONLY)

West 3rd Street between LaGuardia Place and Thompson Street

HANDICAPPED ACCESS

Nine wheelchair / disability seating locations available, accessible through the main theater entrance.
Wheelchair access to stage through stage door entrance.

Infrared Assisted Listening Devices available upon request.

Skirball Center for the Performing Arts

CONTACTS

EXECUTIVE DIRECTOR

Jay Wegman
212.998.2346
jay.wegman@nyu.edu

PRODUCTION MANAGER

Alberto Ruiz
212.992.8497
alberto.ruiz@nyu.edu

TECHNICAL CREW HEADS

Don Short, Audio & Rigging Supervisor
don.short@nyu.edu

Emily Anderson, Lighting Supervisor
e.anderson@nyu.edu

Brian Emens, Crew Head
George Faya, Crew Head
Angie Golightly, Crew Head

Production Office: 212.992.8161

OPERATIONS MANAGER

Jenny Liao
212.992.8480
jenny.liao@nyu.edu

FRONT OF HOUSE SUPERVISOR

Jordan Peters
212.992.8480
jxp10017@nyu.edu

EMERGENCIES

All Emergencies: 911
NYU Public Safety Emergency: 212.998.2222
Kimmel Center Security Desk: 212.998.1319
Fire Department: Patrol 2 3rd St. and Thompson
Police Department: 6th Precinct West 10th St

OPERATIONS DIRECTOR

Ian Tabatchnick
212.992.8486
it9@nyu.edu

FINANCE & ADMINISTRATION MANAGER

Caroline Steudle
212.992.8483
caroline.steudle@nyu.edu

ADMINISTRATIVE COORDINATOR

Zakiya Rowe
212.992.8487
zsr2003@nyu.edu

TICKETING SERVICES

Craig Melzer
212.992.8473
craig.melzer@nyu.edu

Clifford Billings
212.992.4421
clifford.billings@nyu.edu

MARKETING AND COMMUNICATION

Clare Lockhart
212.992.8499
cll430@nyu.edu

DEVELOPMENT DIRECTOR

Kimberly Olstad
212.992.8482
kimberly.olstad@nyu.edu

Skirball Center for the Performing Arts

FACILITY

SEATING

Total Capacity (with orchestra pit seating): 853

Total Capacity (no seats on orchestra pit): 791

Orchestra: 440

Parterre: 168

Balcony: 183

Orchestra Pit: 62

The number of sellable seats may differ from the above counts.

REMOVABLE SEATS

The following permanent seats can be removed:

Orchestra F 106-110

Orchestra G 106-110

Orchestra N 108-114

Orchestra O 108-114

Orchestra P 108-114

The following are loose, removable, seats:

Orchestra Box House Right 2-24

Orchestra Box House Left 1-23

Parterre Box House Right 2-10

Parterre Box House Left 1-9

Orchestra U 101-106

Orchestra U 115

Balcony E 1-5

Balcony E 2

Most other seat pans and backs are removable; however arms are not.

Several of the above locations are reserved for ADA patrons, and removal may not be possible. Additional work call may be required to remove seats. Please discuss with Operations Director and Ticket Services Managers prior to your event going on sale.

INTERNET CONNECTIVITY

The Skirball Center is equipped with password protected Wi-Fi internet access, the password changes weekly. Wi-Fi passwords posted backstage.

Wired internet connectivity is available through a limited number of ethernet ports distributed throughout the theater and technical booths. Prior registration of machines ethernet mac address required. Bandwidth is not guaranteed, though generally sufficient for high quality live streams. Network switches are not permitted on the NYU network. Contact Production Manager one month prior to your event for device registration.

Dark Verizon fiber available upstage right. Renter responsible for coordination and cost of enabling service. Contact Production Manager at least one month prior to your event for more information.

STORAGE/DELIVERIES

Storage space is limited and only available during contracted time in the space. No deliveries can be made prior to your scheduled load in time. No items can remain after the load out of your event.

Skirball Center for the Performing Arts

LOADING IN, TRUCK PARKING, AND PERMITS

LOADING IN

The Skirball Center stage is two stories below street level. Please verify that everything you plan on bringing into the venue will fit in the freight elevator from dock height.

Street level passenger elevator available at stage door entrance for small items.

LOADING DOCK

The loading dock is on West 3rd Street between LaGuardia and Thompson. Only one bay is available. Trucks over 26' cannot back into the dock. The Skirball Center does not have a truck ramp or plate.

Dock is shared with the entire building, and available on a first come first serve basis. Trucks may not be parked inside the dock unless actively loading or unloading. One Skirball crewmember may be required to remain in the dock while the dock door is open.

Dimensions of Truck Bay: 28' x 12'

Dock Height: 2'-9"

No dock leveler, dock plate, or truck ramp.

We recommend trucks with lift gates, as the dock is below standard truck height.

Upstage Loading Door: 10'-4" high x 12'-0" wide

FREIGHT ELEVATOR

Dimensions: 12'-0" long x 9'-6" high x 5'-10" wide

PARKING & FILM PERMITS

An official Motion-Picture Television Permit is required for parking vehicles in a non-authorized location as well as for film shoots asserting use on City property. Forms, fees and more information can be found at:

Mayor's Office of Film, Theater and Broadcasting

<https://nyceventpermits.nyc.gov/film/>

Skirball Center for the Performing Arts

CARPENTRY

STAGE DIMENSIONS

Proscenium: Width: 45'-9" (Inside of Proscenium Columns)
Height: 32'-0" to canopy

Width: Wall to Wall: 82'-4"
Wall to Rail: 78'-4"
Wall to Fly Bridge: 70'-4"
Proscenium Walls: 68'-0"

Prosc. Opening: 29'-4"

Stage Depth: 29'-6" from plaster line to upstage wall
35'-8" from downstage edge of stage to upstage wall
46'-9" from downstage edge of orchestra pit to upstage wall

Grid Height: Under hung Grid 39'-4" above deck

Gridded Height
of Battens: 35'-6"

Gridded Height
of M1-M4: 22'-7" (see section drawing)

Orchestra Pit: 43'-7" wide x 17'-9" deep
Height is adjustable.
Maximum depth of 6' below floor of the house.

Stage Height from Audience Floor (front row): 3'-5"

STAGE FLOOR

Sprung dance floor with black arboron top surface
No nailing, screwing, or stapling allowed.
Only gaffers tape may be adhered to the stage.

Black Harlequin Cascade Dance Floor available.
No rosin permitted.
Only gaffers tape may be adhered to the dance floor.

Skirball Center for the Performing Arts

HOUSE DRAPERIES

Main Curtain:	Gold IFR 25oz Charisma Various (permanently hung on dead hung traveler track) Two Panels, each 32'-9" tall x 39'-9" wide
Valence:	Black IFR Polyester Curtain (permanently hung on Valance pipe) One panel, 8'-0" tall x 73'-6" wide
Legs:	Black IFR 20oz Crescent Velour Six panels 32'-9" tall x 10'-0" wide Two panels 30'-0" tall x 12'-0" wide
Borders:	Black IFR 20oz Crescent Velour Four panels 10'-0" tall x 63'-0" wide
Travelers:	Black IFR 20oz Crescent Black (permanently hung on DS Traveler & Lineset 20) Four panels (two travelers) 32'-9" tall x 34'-5" wide
Scrims:	Black FR Scrim White FR Scrim One panel each, 22'-7" tall x 57'-0" wide
Cyc:	White FR Seamless Muslin Cyc One panel, 22'-7" tall x 57'-0" wide
Bounce:	White FR Muslin Bounce One panel, 22'-7" tall x 57'-0" wide
Other:	Two IFR Black column cover sleeves

PIPE & DRAPE

Hardware:	12) Bases 12) Extendable Uprights 9'-0" to 16'-0" 2) Extendable Uprights 6'-8" to 12'-0" 2) Extendable Uprights 4'-4" to 7'-4" 11) Horizontal Pipe 7'-0" to 12'-0" 2) Horizontal Pipe 6'-0" to 10'-0" 1) Horizontal Pipe 4'-0" to 7'-0"
Soft Goods:	6) Black IFR 15oz Encore 12'-0" tall x 4'-10" wide 11) Black IFR 15oz Encore 12'-0" tall x 12'-4" wide

Skirball Center for the Performing Arts

LINESETS (Lineset 1 – Lineset 20)

Working Height

of Battens: 4'-0"

Gridded Height

of Battens: 35'-6"

Battens: 63'-0" long, single pipe, 1250 lbs evenly distributed

Type: Single Purchase

Arbor Capacity: 12' Arbor, ~1250 lbs of weight

Available Wt.: ~18,000 lb: 28 lb bricks & 14 lb bricks

Loading Gallery: 3 elevated levels for loading

Pin Rail: None. Lock Rail is elevated above deck SR.

UPSTAGE MOTOR PIPES (Motor Pipe, M1 – M4)

Motor Pipe: 57'-0" long, single pipe. Hung from 3x 1/4T chain motors, controlled from backstage right.

M1 – M4: 57'-0" long, single pipe. ETC Paradigm winches, controlled from backstage right.

Max out trim: 22'-7"

Max load: 1000lbs evenly distributed.

VALANCE PIPE

8' tall border on movable lineset; Max in while masking above for front row without orchestra pit seats: 22'-2"

Adtl sched40 pipe tailed down 6' from Valance Pipe for adtl border, 44'-0" long, 60 lbs max evenly distributed

PLATFORMS

21) Wenger Versa Deck 4' x 8' Black Top

Legs to make the following heights:

10) platforms at 8"

10) platforms at 16"

5) platforms at 24"

4) platforms adjustable 24" - 40"

2) platforms adjustable 30" - 54"

1) Wenger Conductor Platform, Grey Top, 43" x 38.5" x 6.5"

CROSSOVER

Crossover from USL to USR through dressing room hallway.

On stage crossover possible upstage of black traveler, if cyc is not used.

SCENE SHOP

No construction is permitted on site.

Skirball Center for the Performing Arts

LIGHTING

LIGHTING CONTROL NETWORK

ETC EOS Ti 24k Console

1) 2x20 Universal Faderwing

1) Puck (as RVI) and 2 Flat screen monitors for Tech Table

DIMMERS

312) 2.4k ETC Sensor 3 Digital Dimmers for stage use.

96) 2.4k ETC Sensor 3 Digital Dimmers for House, Lobby, Work Lights.

NETWORKING

ETC Network connections at Light Booth, Tech Table, Stage Left, Stage Right, Audio Mix Position, Video Booth.

Multiple DMX dry lines connected to patch panel in lighting booth

HOUSE LIGHTING

Control via Paradigm stations, or as channels on lighting console.

CIRCUITS

288 Dimmers: Dimmer per circuit, Stage pin connectors.

24 Dimmers: Circuits run to Apron Truss & FOH Catwalks, Stage pin connectors.

208V CIRCUITS

L6-20 Twist lock. Two per position on electrics 1 – 4, 4 in each catwalk (8 total), 1 at upstage back wall.

COMPANY SWITCHES

2) 400 Amp 3-Phase Company Switches Stage Left with Cam- Lok Tails (N/G reversed)
(one switch permanently powers house Apron Truss & Catwalks 24-rack)

1) 200 Amp 3-Phase Company Switch in Box Office Hallway (Balcony / Street Level) with Cam-Lok Tails
(N/G reversed)

1) 100 Amp 3-Phase Company Switch Upstage with Lug terminals (no tails installed)

House main dimmer racks are permanently installed, separate from above company switches.

Lighting Positions

All lighting positions are 1.5" ID schedule 40 pipe, with the exception of Balcony Rail and Parterre Boxes Left & Right, which are 1.25" ID schedule 40 pipe.

Skirball Center for the Performing Arts

INSTRUMENT INVENTORY

Units listed as spare are stored in the lighting shop. Units in the Rep Hang are hung per the rep light plot.

Units in Rep Hang:

- 35) Source Four 19° 750w
- 49) Source Four 26° 750w
- 68) Source Four 36° 750w
- 4) Source Four 50° 750w
- 20) Source Four PAR WFL 750w
- 2) Source Four Lustr2 19°
- 20) Source Four Lustr2 26°
- 6) Source Four Lustr2 36°
- 25) Desire Fresnel Lustr X8
- 8) ChromaQ Colorforce II Plus 72 with cyc lenses
- 1) Atomic3k LED strobe
- 1) Ultratec Radiance Hazer

Six additional ChromaQ Colorforce II Plus 72 available as a ground row upon request. Not set as part of rep plot.

Additional Inventory:

- 60) Source Four Bodies
- 4) Source Four 10° Barrel
- 33) Source Four 19° Barrel
- 39) Source Four 26° Barrel
- 20) Source Four 36° Barrel
- 14) Source Four 50° Barrel
- 2) Source Four Lustr2 36°
- 18) Source Four PARs – VNSP, NSP, MFL, WFL available for all Source4 PARs
- 3) Selador Vivid R series 63"

FOLLOW SPOTS

- 2) Robert Juliat Super Korrigan 1200W HMI Spot Lights in lighting booth (back of balcony)
- 2) 750w ETC Source Four 10° w/handle and iris available upon request

BOOMS

- 8) 7'-0" Dance towers
- 2) 10'-0" Booms
- See plot for instrumentation, they are pre-built
- Booms & dance towers are not set as part of the rep plot. Available upon request.
- 8) 50lb boom base & various lengths sch. 40 pipe
- 4) 4'-0" Adjustable Rover Stands
- 3) 6'-0" Adjustable Rover Stands

Skirball Center for the Performing Arts

CYC

Upstage cyc pack consists of (from upstage to downstage):

- 1) Seamed muslin bounce drop
- 8) ChromaQ Colorforce II Plus 72 units hung on 5th electric.
- 8) ChromaQ Colorforce II Plus 72 used as ground row available upon request (not set as part of rep plot)
- 1) Seamless white muslin cyc
- 1) Black scrim (white scrim available)

CABLE

Basic supply of 5', 10', 25', 50', 100' 2P&G stage cable and two-fers.

Supplemental supply of 5', 10', 15', 25', 50', 75', 100' 5pin DMX cable

Supplemental supply of 25', 50', 75' 6 circuit Multi with Break Ins and Outs

STREET CABLE ACCESS

Removable plates at LaGuardia Place allow cable pass-through into the building, can be distributed to multiple locations in the house, booths and catwalks.

Skirball Center for the Performing Arts

AUDIO

GENERAL

The house sound system is composed of d&b AudioTechnik speakers and amplifiers, connected to the mix position via Dante. All delay (timing) and EQ settings are done at the amplifiers using the d&b AudioTechnik R1 Software.

The sound system is capable of producing peaks at 100 dB (A-weighted) at the Front of House.

The default Dante, Rivage, and ArrayCalc file are available on request

THE SKIRBALL CENTER RESERVES THE RIGHT TO LIMIT THE SYSTEM OUTPUT AT ANY TIME.

MIXING CONSOLES

Yamaha PM10 Rivage mixing system consisting of a **CS-R10** at the FOH mixing position connecting to (2) **DSP RX EX** units (running in redundant mode). We also have a **CS-R10s** available for use as a monitor desk or in the case of an alternate mixing position.

INPUT/OUTPUT

There are (3) Yamaha RPiO I/O boxes connected with Twinlane (Fiber), as follows:

(M1) RPiO622 (64 in, 16 out) located Back Stage Right

(M2) RPiO622 (64 in, 16 out) located Back Stage Left

(M3) RPiO222 (16 in, 16 out) located at the FOH mixing position

Various Analog I/O located throughout the space, primarily used for connecting Monitor cabinets and backstage feeds.

Dante - There are network switches located Back Stage Right and at the FOH mixing position to connect to the Dante network. Several of the I/O boxes and DSPs have Dante cards installed as well.

Contact the Production Manager or the Sound Department for details. Requests to use additional consoles or to make significant changes to the Dante or amplifier setup should be made at least one month prior to your event.

SOUND MIX POSITION

Last row of Parterre, slightly left of center.

Skirball Center for the Performing Arts

DEFAULT OUTPUT ROUTING

The Left and Right Line arrays are fed directly from the **Stereo A Main Out** channels, while the Center Cluster, Truss Fills, Delays and other supplemental cabinets (including Program and backstage feeds) are fed via **Matrices**, sourced from the **Stereo A Main Out** channels. A detailed Output list and/or Routing Map is available upon request

The **Stereo B Main Out** channels feed the 4 channels for recording. Two of which are available as XLR connections in the video booth behind the Audio FOH position. There is also a single XLR cable either side of the FOH Audio position for camera record positions in the house.

The Ground Subs (Left and Right) are on a bus.

FIXED SPEAKERS (Mains and fills)

- Left/Right line arrays of d&b Y8, Y12, Y sub
- (2) d&b V7P Truss Fills (Truss over Stage Apron covering the balcony)
- (3) d&b C7 Center Cluster (routed LCR, Truss over Stage Apron))
- (6) d&b E5 Front Fills
- (6) d&b E5 Orchestra Pit Seating Front Fills
- (5) d&b E3 Under Balcony Delay
- (2) d&b V7P Balcony Fill
- (4) d&b E3 Balcony Delay

MONITOR WEDGES

- (10) d&b M6 monitor wedges (2 channel, non powered)
- (4) flying brackets available upon request
- (10) channels for Monitors (d&b 10D amplifiers)

BACKSTAGE MONITOR/PAGING

- Paging to Backstage Hallway and Dressing Rooms available.
- Program feed to Dressing Rooms, Backstage Hallways, and Lobby.

ASSISTED LISTENING SYSTEM

- Sennheiser HC230 Infrared System
- Headset and T-coil receivers are available for checkout through House Management

CLEARCOM

- Clear Com SB440 - 4 channel base station
- Single channel and two channel belt packs with headsets to support FOH Audio, Lighting Booth, SL, SR, two Spots, Video.
- Additional headsets are available.
- (5) HME Wireless Units (Headset and Transmitter Pack), Single Channel

Skirball Center for the Performing Arts

WIRELESS MICROPHONE SYSTEM

- (12) Channels of Sennheiser D6000 Wireless Receivers
- (12) Sennheiser SKM 6000 Wireless Handheld Transmitter w/ Sennheiser MMD cardioid e935 capsule
- (12) Sennheiser SK 6000 Wireless Beltpack Transmitters w/ Sennheiser MKE2-4 capsule (black)
 - Limited number of MicroDot to LEMO adapters available upon request.
 - Limited number of Black, White, and Beige mic belts available in various sizes.

Either beltpack or handheld transmitters can be used with receivers, mix and match up to 12 channels per performance.

WIRED MICROPHONES & DI BOXES

- | | |
|---------------------------|---|
| (11) Shure SM57 | (1) Audix D6 |
| (11) Shure SM58 | (2) Audix D2 |
| (4) Shure SM58 Switchable | (2) AudioTechnica Lectern Microphones |
| (4) Shure Beta 57A | (4) AKG C414 (2 matched pairs) |
| (1) Shure Beta 52A | (2) Sennheiser ME67 |
| (1) Shure Beta 87A | (2) Sennheiser MKH 50-P48 |
| (4) Shure KSM 32 | (2) DPA 4099 |
| (2) Shure KSM 184 | (2) Piano Mounts |
| (4) Shure KSM 141 | (1) Violin Clip |
| (4) Shure KSM 137 | (1) Cello Clip |
| (4) AudioTechnica AT 8531 | (1) Rolls MS III Microphone Switch |
| (3) Crown PCC 160 | |
| (2) Neumann KMS 105 | (2) ProCo - DB1 Direct Box |
| (3) Sennheiser MD 421 | (7) Countryman - DI 85 Direct Box |
| (3) Sennheiser E604 | (4) BSS AR133 Direct Box |
| (2) Sennheiser E609 | (4) Whirlwind – PC DI Stereo Direct Box |
| (6) Countryman Isomax | (4) Radial Engineering USB DI |

We have an inventory of **DPA 4066** Headworn microphones available in beige and brown. Contact the Production Manager or Sound Supervisor for specific needs and current availability.

Specific microphone availability not guaranteed. Please contact the Production Manager with your needs.

PLAYBACK

- (1) M1 Mac mini with licensed copy of **Qlab 5** is connected to the FOH console via **Dante Virtual Soundcard** for playback
- (1) **Denon 500CB CD/USB/Bluetooth Media Player** is installed for rehearsal playback on stage. For details on connecting to it via Bluetooth (or otherwise), contact the Production Manager or Sound Department

Skirball Center for the Performing Arts

CABLE/PATCHING

48 channel iso-split with 9' & 100' fan outs available upon request.

XLR, XLR sub snakes, and NL4 cables in varying lengths available.

Limited supply of ¼" instrument cables available in house. Musicians should supply their own when possible

VIDEO

PROJECTOR, SCREEN, SWITCHER

Christie Crimson WU25 3DLP Laser Projector (1920x1200 native resolution)
Permanently hung on Balcony Rail.

1.8 - 2.6:1 Zoom Lens (Rep installed lens)

2.6 - 4.1:1 Zoom Lens available upon request

(1) 25' x 15' (5:3 ratio) Front Projection Screen permanently hung over stage.

(1) Analog Way Pulse2 video switcher

With use of video switcher, we can accept signal as DVI, VGA, HDMI, or SDI. DVI preferred.

INFRASTRUCTURE

Dual-core SC terminated multimode OM3 fiber run between Video Booth and Balcony Rail.

One pair of DVI over Fiber converters permanently installed (Gefen EXT-DVI-FM1000).

Quad-core SC terminated multimode OM3 fiber run between Video Booth and Backstage Right.

Two pair of DVI over Fiber converters available upon request (Gefen EXT-DVI-FM1000).

One pair Ethernet over Fiber converters available upon request (TRENDnet TFC-1000MSC).

Miscellaneous short SC terminated simplex multimode fiber patch cables.

3x HDSDI and 2x Cat6 dry lines between Video Booth & Balcony Rail.

3x Cat6 dry lines between Video Booth & Backstage Right.

LIVE STREAMS / NETWORK SIMULCAST

Wired internet connectivity is available through a limited number of ethernet ports distributed throughout the theater and technical booths. Prior registration of machines ethernet mac address required. Bandwidth is not guaranteed, though generally sufficient for high quality live streams. Unmanaged network switches are not permitted on the NYU network with very limited exceptions. Contact Production Manager one month prior to your event for device registration.

Dark Verizon fiber available upstage right. Renter responsible for coordination and cost of enabling service. Contact the Production Manager at least one month prior to your event for more information.

Cable pass-throughs available to Production or Satellite truck parked on LaGuardia Place.

208V POWER

Skirball Center for the Performing Arts

One 20 amp 208v circuit available in the video booth. Two L6-30 plugs.

STAGE VIEW CAMERA

HD (1080i) stage view camera located on balcony rail. Monitors located backstage left and right. SDI loop through of camera feed available backstage left and right at monitor, and in FOH video booth.

HD Cable TV video distribution system with monitors in green room, rehearsal room, and lower lobby (late seating monitors).

Skirball Center for the Performing Arts

PROPS & WARDROBE

WARDROBE ROOM

Wardrobe Room accessible thru backstage hallway near Rehearsal Room

One Iron, Ironing Board, and Steamer
(3) Costume Racks

LAUNDRY ROOM

Laundry Room located backstage, near Rehearsal Room.

One washer, one dryer
Fastest washer cycle: 26 minutes

PIANOS

Steinway Model B 6'-11" Classic Grand
Baldwin Model R 5'-8" Grand (stored in rehearsal room, additional cost to move to stage)
Two Yamaha U1 Upright Pianos

MUSIC STANDS

(40) Wenger Rough Neck Music Stands (Black)

MUSIC STAND LIGHTS

(20) 40-watt

CHAIRS

(90) Black padded orchestra chairs
(30) Grey padded orchestra chairs

DANCE FLOOR

Black Harlequin Cascade Dance Floor Available

LECTERN

(1) 47.5" x 31" wooden lectern with computer shelf (Painters Tape Only)
(1) 46.5" x 32" wooden lectern with computer shelf (flat surface to tape graphic onto)
(2) Lucite Lecterns (Matching) (Painters Tape Only)

TECH TABLES

(1) 8' x 4'
(1) 4' x 4'
(1) 4' x 3'

Skirball Center for the Performing Arts

DRESSING & REHEARSAL ROOMS

DRESSING ROOMS

A: 15'-7.5" x 14'-6" 3 mirror stations, 2 sinks, 1 shower, 1 toilet

B: 20'-10" x 14'-6" 6 mirror stations, 2 sinks, 1 shower, 1 toilet

C: 21'-10" x 14'-6" 7 mirror stations, 4 sinks, 1 shower, 1 toilet

REHEARSAL ROOM

Dimensions: 32'-6" x 30'-6" x 7'-9"

Collapsible ballet barres available. No mirrors.

RESTROOMS

Single Stall Restrooms: One next to Green Room; Two next to Laundry / Skirball Production Office

Men's & Women's Restrooms Locker Rooms located next to Rehearsal Room (1 sink, 1 shower, 1 toilet each)

GREENROOM

Dimensions: 30' x 14'-6"

Refrigerator, microwave, couches, chairs

STAGE MONITORS

Dressing Rooms, Rehearsal Room, Green Room, and Backstage Hallways have audio feed from the stage.

Green Room and Rehearsal Room have HD video monitor from the stage as well as stage audio feed.

BACKSTAGE LAYOUT (not to scale)

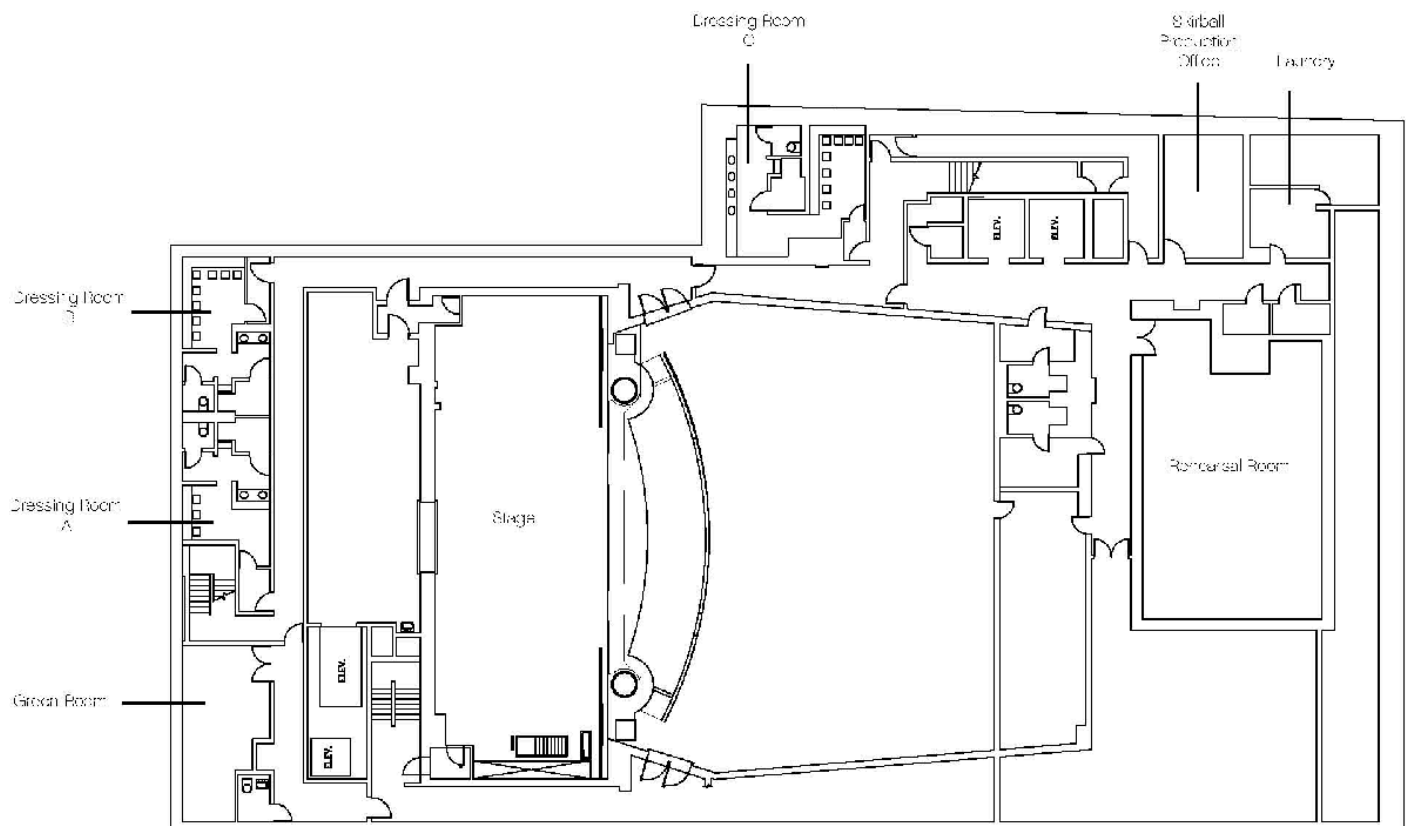

Skirball Center for the Performing Arts